

New!! Armstrong Seismic Expansion Joint System!!!

Note: The SJCG is not included within the ICC-ESR 1308 report. Its use is subject to approval from the local building authority.



Expansion joint constructed using Armstrong SJCG System! Invisible once tile is installed! No additional materials, less labor!

Example of a "field constructed" Expansion Joint. Note the extra materials required, also substantial labor costs to construct!

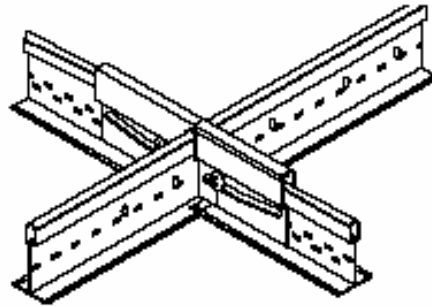

Key Selection Attributes

- Armstrong conducted full-scale testing at the State University of New York, University at Buffalo which provides evidence of performance in IBC Category D, E, and F installations
- SJCG gives architects and designers a clean look and saves contractors time with a reliable installation method.
- Installs in minutes, no need to cut the face of the grid to install clip
- Eliminates the need for additional hanger wires
- Lower material costs than many other common systems
- Maintains integrity of ceiling module
- Not visible from below
- Easier to keep grid system square
- Allows the use of full size panels

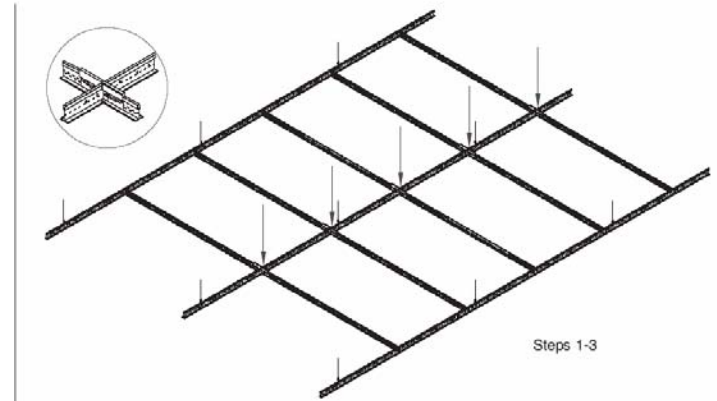

Steps 1-3

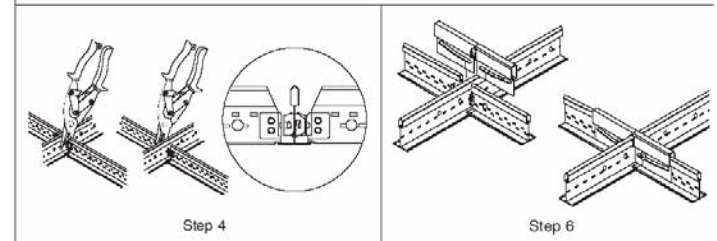

Step 4

Step 6

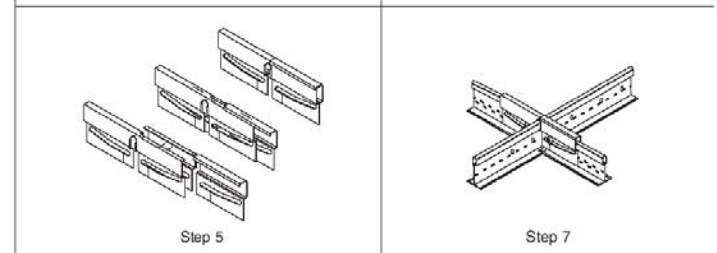

Step 5

Step 7

Please call me to update your Ceiling Specification or for any questions about this system or any other ceiling related issue!
Zachary Thon, Arch. & Contract Sales Manager
Mountain States Territory, West Region
Direct Phone: 801-737-4569 FAX: 801-737-4572

